

The City Of Southside Place Benchmark

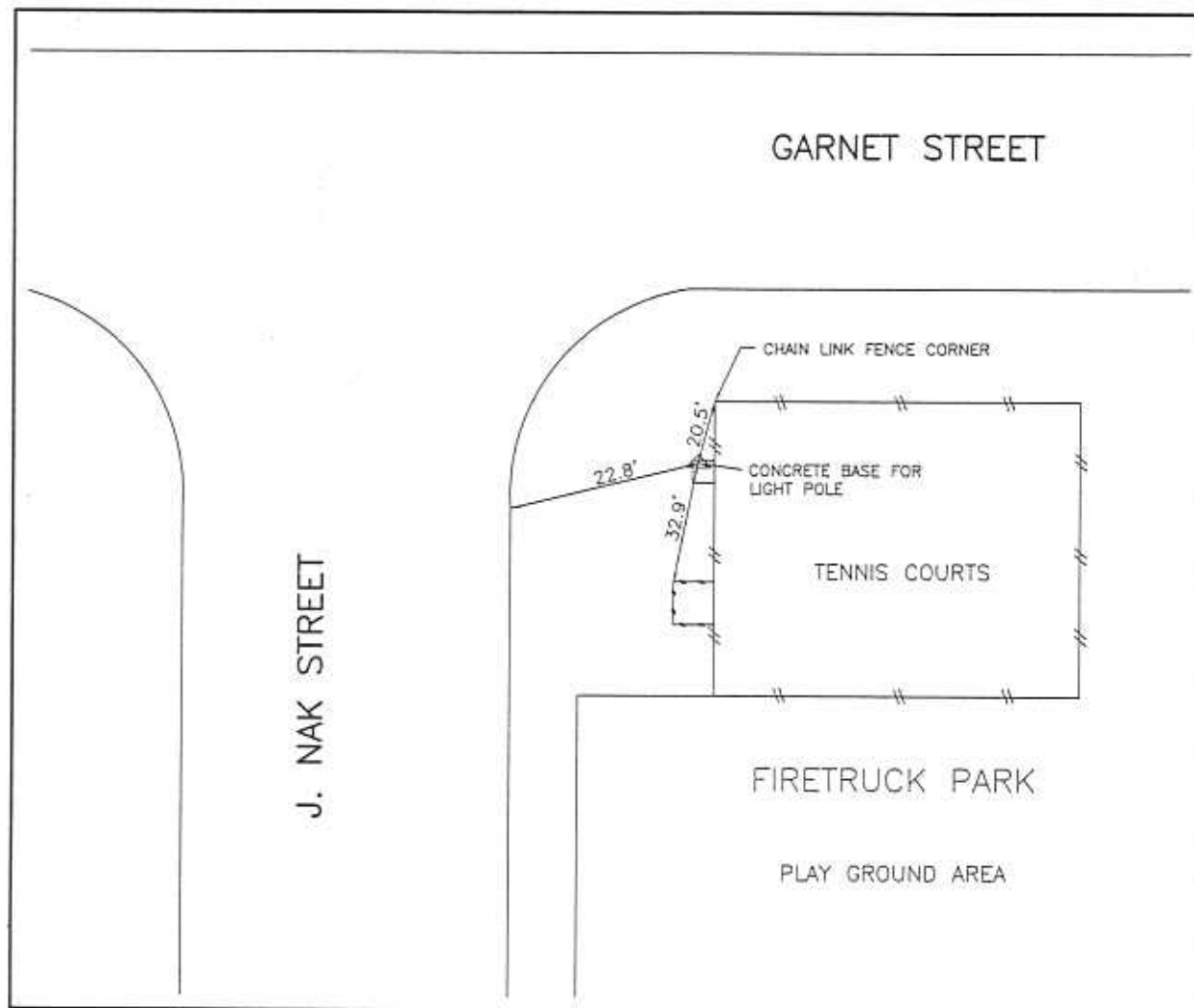

ELEVATION: 49.36 NAVD88, 2001 Adjustment

UNIT OF MEASURE: U.S. Survey Foot

DESCRIPTION: Set 2" brass disk on top of the concrete base of light pole adjacent to the tennis court at Firetruck Park

DATE SET: June, 2004

LANDTECH CONSULTANTS, INC.
Civil Engineering • Land Surveying
2627 North Loop West
Suite 224
Houston, Texas 77008